

Terraçade™ TN Mitred Corner Installation Instructions

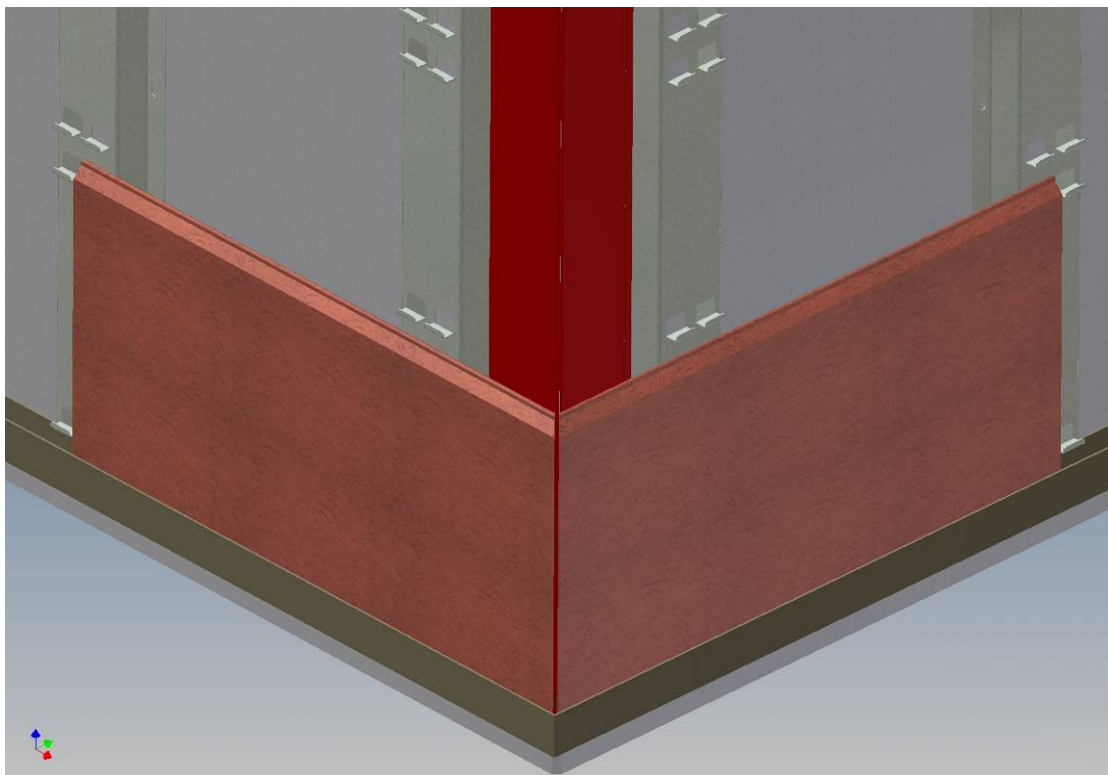

The TN Mitred Corner provides an effective method of allowing the natural textures and colours of the Terraçade TN range to flow around the corners of buildings.

The TN Mitred Corner consists of two Terraçade TN tiles cut to a special angle so as to provide a pleasing aesthetic appearance while minimises damage to the tile edge due to its unique design. A specially designed aluminium 'Y' Fin extrusion is the only addition to the standard Terraçade TN fixing system thereby making the TN Mitred Corner pleasing to the eye and the pocket. Being aluminium, like the rest of the TN fixing system, the aluminium Fin can be powder coated or anodised so it acts as a shadow line, complements the tiles or is a bold contrast effect.

Fixing Details

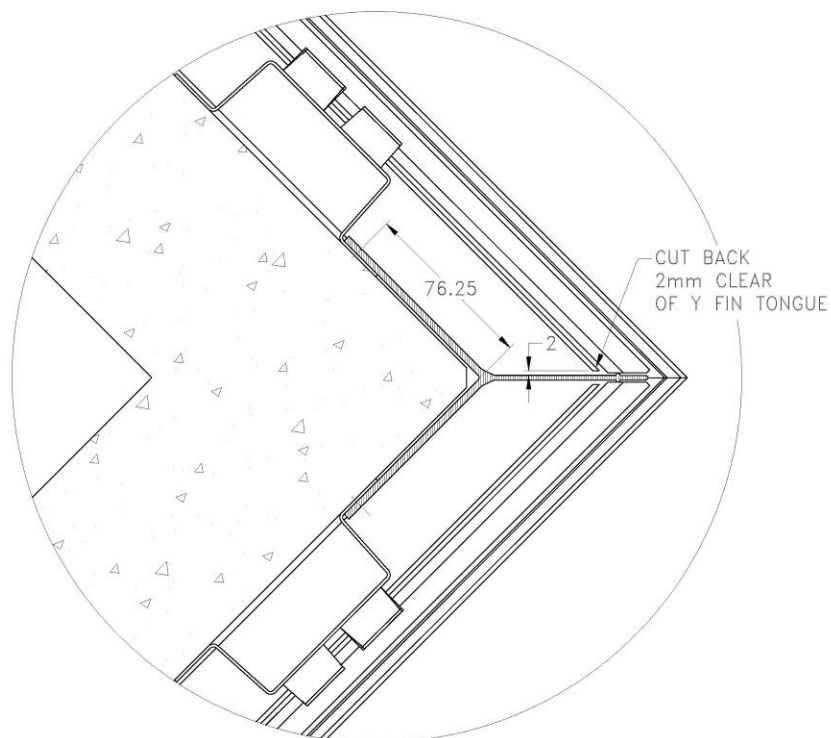
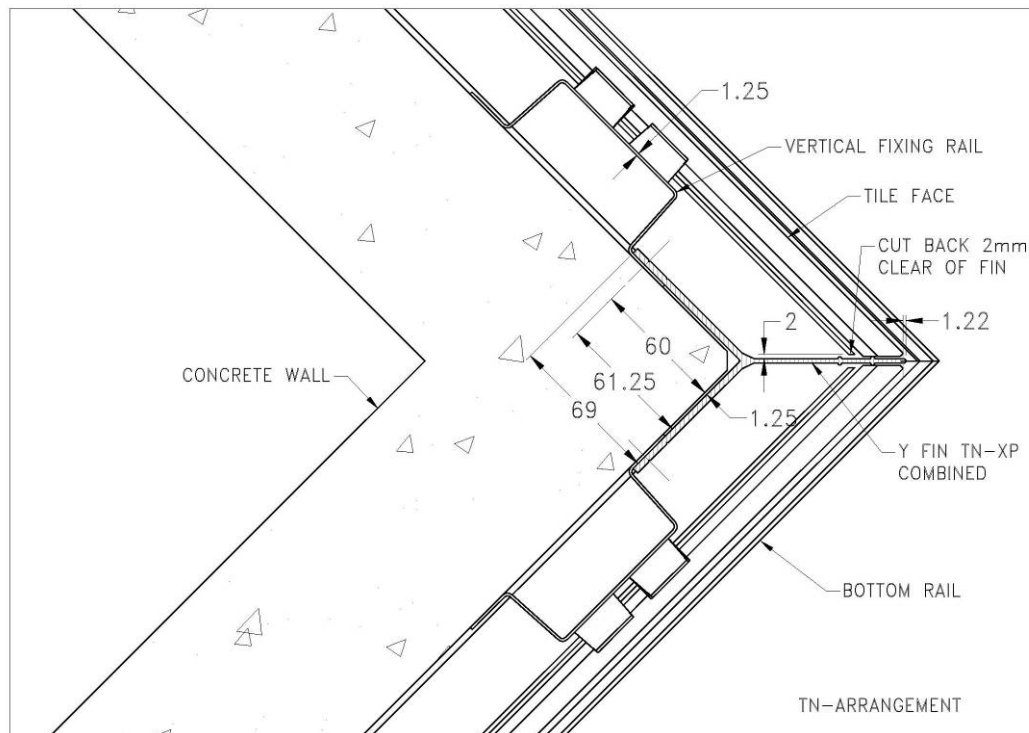

To ensure that the 'Y' Fin sits into the Surround snugly, the upright leg of the Surround needs to be notched out (with an extra 2mm clearance) to allow for the 'Y' Fin to sit inside the Surround. The minimum tile size is 400mm.

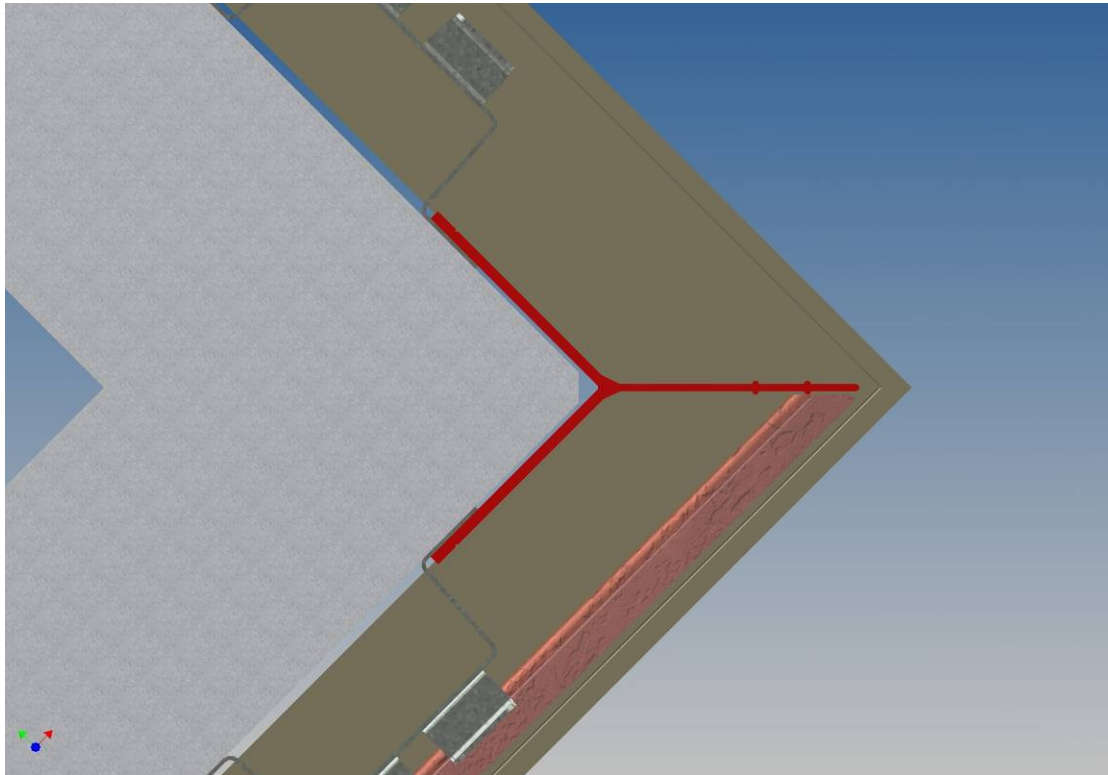

This view shows the 'Y' Fin sitting on top of the Vertical Suspension Rail. The 'Y' Fin is fixed to the substrate through the fixing holes in the Vertical Suspension Rail.

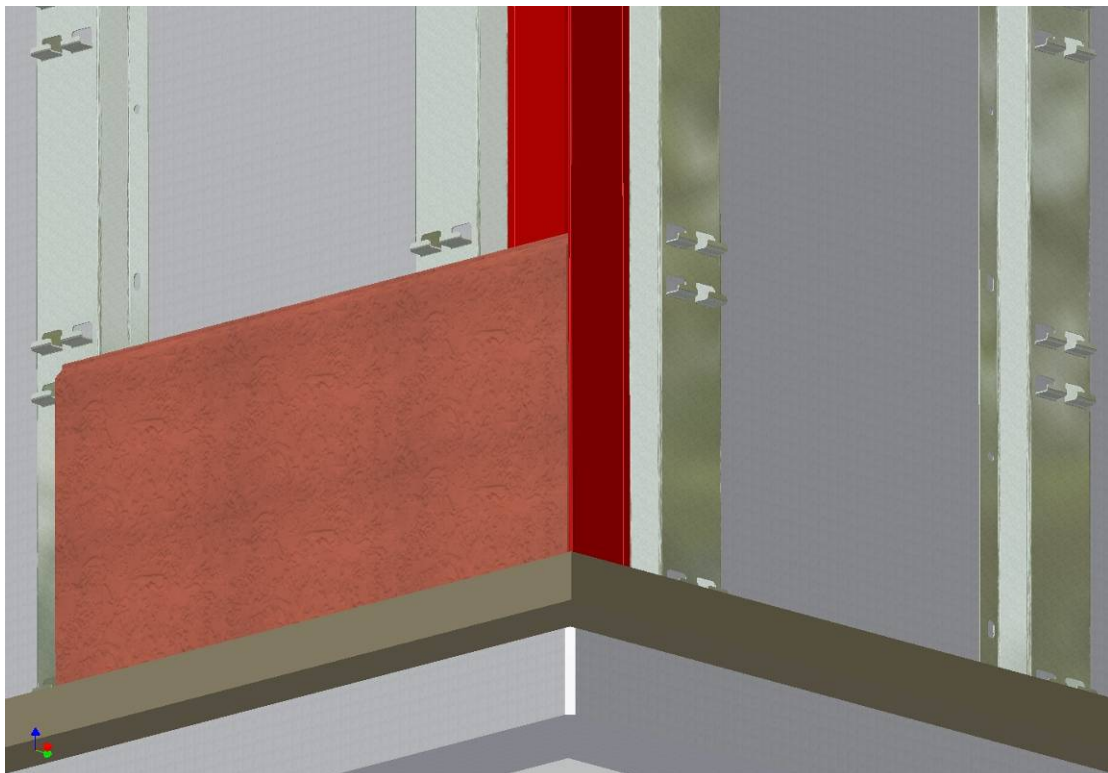

Looking from the bottom you can see that the Surround shows only the normal mitre as it is the upright leg of the Surround that is cut to accommodate the 'Y' Fin.

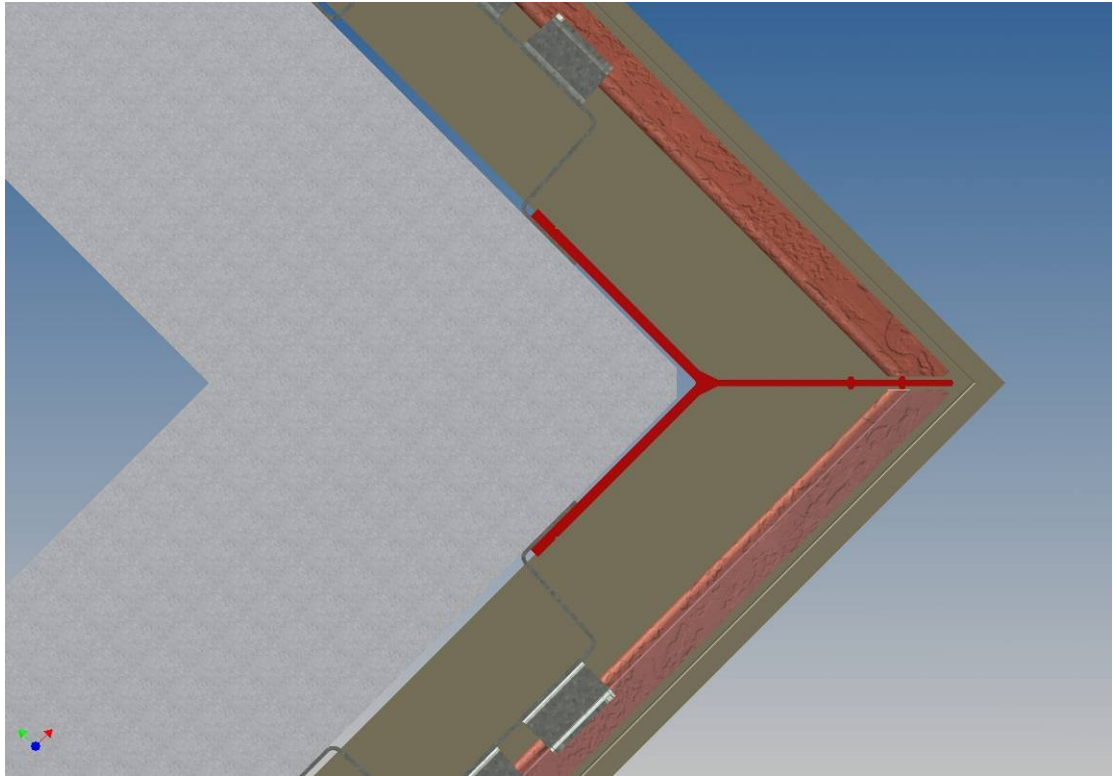

Top view showing 'Y' Fin installed and the TN Mitred Corner tiles in place.

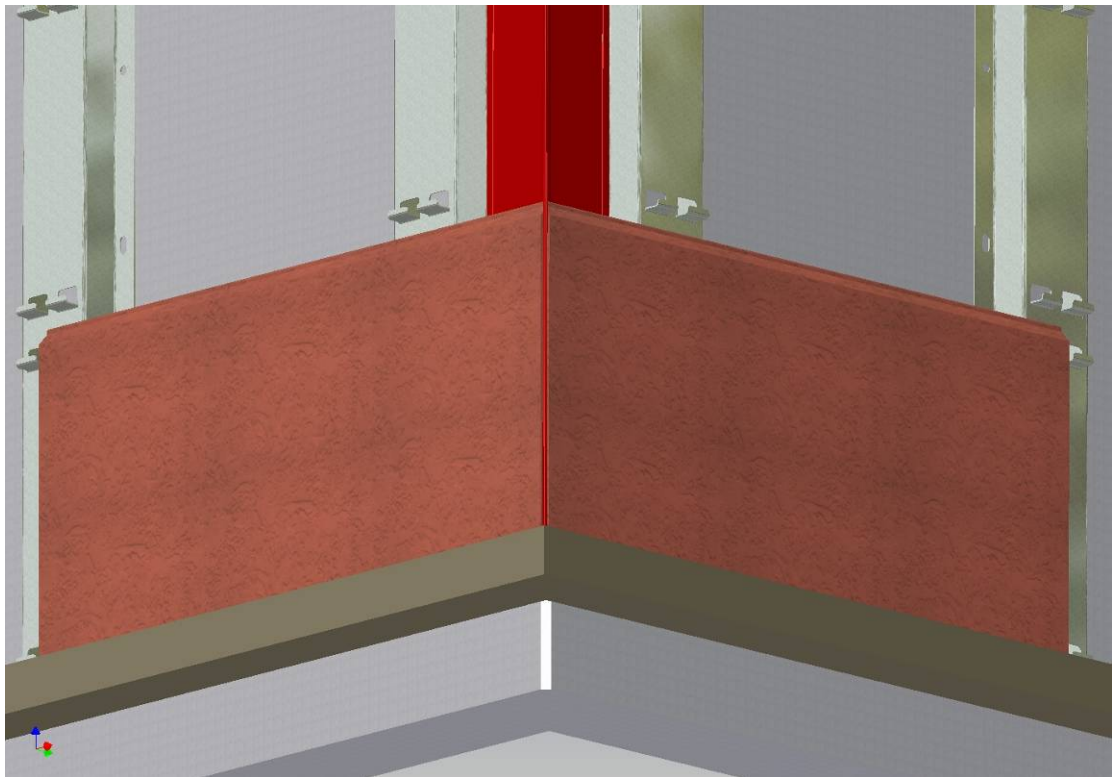

Front view of completed TN Mitred Corner.